



Photo Courtesy of Pinellas County Jail, Clearwater, Florida

MRF Series Modular Ruggedized Furniture

Strike Industries Inc. is one of the industry's leading suppliers of ruggedized equipment enclosures for use in applications such as inmate video visitation, video arraignment, video consultation and more. Strike's MRF enclosures are available in flush mount, wall mount, floor mount and mobile configurations. MRF enclosures are designed to withstand the rigors of daily use in both the inmate housing and visitor environments.

Durability, flexibility and competitive price are the key factors that drive Strike's design. Strike's MRF series modular design meets the needs of virtually every system equipment supplier across a wide range of applications.

All MRF series enclosures feature Strike's Heavy Duty Cantilevered Hinged Equipment Door (patent pending) that is secured with tamper proof security screws to the various back box configurations offered by Strike. This unique equipment door provides easy access to the interior of the unit and the video communications equipment, and incorporates a VESA mount for LCD monitors supporting monitors up to 17 1/4 inches wide and 18 1/2 inches high and up to 2 3/4 inches deep. It also includes a camera mount and openings for an armored cord handset and hookswitch/cradle. Monitor, camera, handset and hookswitch/cradle are optional equipment not included in the base model.



All MRF series enclosures are constructed of 14-gauge steel with a heavy duty, more resistant 3/8" thick polycarbonate window. MRF enclosures are heavy-duty powder coated for durability and ease of maintenance. Welded steel panels and rugged construction protect equipment from being damaged in environments subject to heavy use and abuse. The viewing area behind the polycarbonate window is 12" H x 15" W.

The **MRF Flush Mount Station** configuration features a 5" deep back box to support installation locations where space is limited. The flush mount configuration's back box can be recessed into concrete block construction or mounted back-to-back in existing non-contact visitation windows to maximize the use of available space. Strike's equipment door is secured to the back box to provide a flush mount configuration that is less than one inch deep on the face of the wall.

Strike offers two Wall Mount MRF solutions. The standard MRF wall mount solution incorporates a 26"H x 26"W x 5"D wall mounted back box utilizing Strike's heavy duty equipment door found on all MRF enclosures. With the addition of the equipment door the overall dimensions of the enclosure are 26"H x 26"W x 6"D for a compact, space efficient installation.

The second MRF wall mount solution features a Wedge design back box exclusively available from Strike for use in areas where privacy and space are a factor. The wedge wall mount back box provides a 30 degree angle to the mounting surface that allows you to control the field of view by rotating the wedge back box 180 degrees.



WEDGE BACK BOX



Strike's **MRF Floor Mount Station** solution is truly modular in design with configuration components that mix and match to support anything from a single floor mounted station to an unlimited number of floor-mounted stations connected as required. Wiring for communications and power can be routed through the legs or from the side or top of the unit. The MRF Floor Mount utilizes the wall mount enclosure with equipment door providing uniformity in all station locations. The four station configuration shown to the left takes up less than ten square feet of floor space measuring just 1'10" x 5'2" at the outside dimensions. Suitable for inmate and visitor locations alike, the all steel construction MRF floor mount components provide an extremely rugged and space economical solution for any environment.

Photo Courtesy of Leon County Jail, Tallahassee, Florida

Strike's **Mobile Visitation Station** is specifically built for the corrections environment. The unit is black powder coated, constructed of 14-gauge steel and has a large polycarbonate window. The unit has heavy-duty locking casters for easy mobility allowing it to be moved from one area to another and then locked in place when in use or placed in storage. Louvered panels on the top and bottom provide air flow through the unit. A removable side panel, along with a removable viewing screen panel, allows access to equipment. Security screws are used throughout to eliminate unauthorized access.



Strike offers several seating options:

Injection Molded Stacking Chair (One-piece with or without arms).



- High-impact, fire retardant polypropylene
- Withstands a static load test of over 400 lbs.
- Each chair weighs only 7 lbs

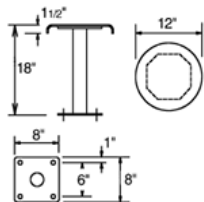

Pedestal Floor Mount Stool

- 14 Gauge type 304 stainless steel top
12" diameter x 1 1/2" deep
- Height: 18" from floor to top of seat
- Base plate: 8x8x1/4" steel base plate,
w/ 4- 1/2" dia holes

